

Hospitalet

H214PS

810mm



Opcional / En option / Optional / Opcional



H214FC



H214E/1

Variantes / Variantes / Alternatives / Variações



H214M/1



H214



H214P



H214-2



H214-4



H214PMR

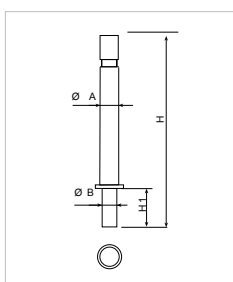

Ref.	Ø A	B	H	H1
H214	95	-	1000	-
H214M/1	95		1005	135
H214P	95		810	
H214PS	95	76	980	185
H214-2	95 mm	-	1200 mm	-
H214-4	95 mm	-	1400 mm	-
H214PMR	95 mm	-	1400 mm	-
H214E/1	95 mm	120 mm	970 mm	170 mm

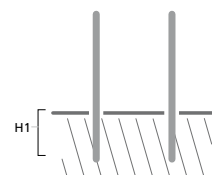

Acero zincado con anillo de acero inoxidable. Imprimación epoxi y pintura poliéster en polvo color negro forja. Instalación: Base empotrable y varillas de rea con hormigón.

Acier zingué avec un anneau en acier inoxydable. Couche primaire époxy et thermolaquage polyester noir de forge. Installation : Base à encastrer et tiges filetées avec béton.

Made of metal and a stainless steel ring with epoxy primer coating and black wrought iron coloured polyester powder coated finish. Fitting: Embeddable base and bars with concrete.

Aço com anel de aço inoxidável com impressão epóxi e pintura poliéster em pó de cor preto forja. Instalação: Base e varetas com cimento podem ser construídas no solo.

